

POS.	Q.TY	DESCRIPTION	CODE
28	1	GASKET	13902
27	1	CAP	14016
26	1	FILTER PROTECTION	14410
25	1	OR 2225	91556
24	1	COVER	14104
23	6	SCREW TCEI M5x34	93642
22	1	SEALING	90123
21	1	OR 3168	91554
20	1	COVER	35136
19	1	FAN	33826
18	4	BRUSH	33620
17	1	FLANGE	31937
16	1	BEARING 6202 2RSC3GJN	91121
15	1	BASE	34345
14	1	CONNECTION	32059
13	1	CONNECTION	32060
12	1	FLANGE	33460
11	1	BEARING 6004 2RSC3GJN	91119
10	1	ARMATURE	31469
9	9	SCREW TCEI M8x54	93637
8	1	WHEEL ø260x101	132147
7	1	SEALING	14310
6	2	BEARING 16024	91111
5	1	OR 3775	91536
4	1	SEALING RING	90115
3	2	COMPENSATION RING	92702
2	2	BEARING 6206 2Z	91133
1	1	IRON CASTING	13040

B	GEARS	12903
A	GEARS	12944

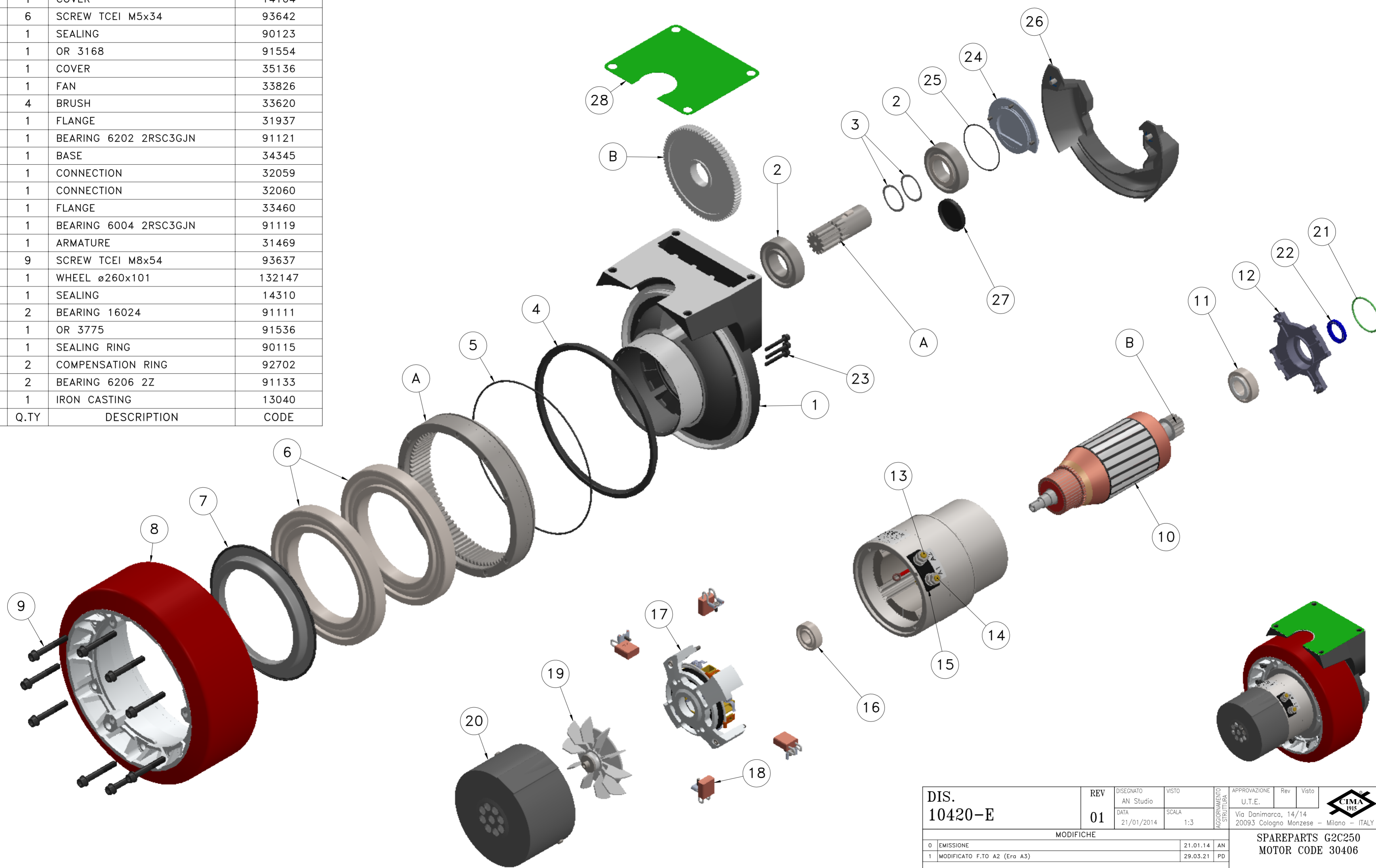

DIS. 10420-E	REV	01	DISegnATO	AN Studio	VISTO	U.T.E.	APPROVAZIONE	Rev	Visto	
	DATA	21/01/2014	SCALA	1:3	AGGIORNAMENTO STRUTTURA	Via Danimarca, 14/14 20093 Cologno Monzese - Milano - ITALY	SPAREPARTS G2C250 MOTOR CODE 30406			
MODIFICHE										36 V / 1500 W WHEEL ø260x101 ELAST. ANTISKID RED Project Nr.
0	EMISSIONE			21.01.14	AN					
1	MODIFICATO F.TO A2 (Era A3)			29.03.21	PD					

CODICE 10420-E
 Disegno eseguito con SW non sono ammesse variazioni o modifiche manuali
 Formato: A2