

POS.	Q.TY	DESCRIPTION	CODE
30	1	GASKET	13908
29	1	PROTECTION	14415
28	1	CAP	14016
27	1	OR 2225	91556
26	1	COVER	14104
25	6	SCREW TCEI M5x34	93642
24	1	SEALING	90123
23	1	OR 3168	91554
22	1	COVER	35136
21	1	FAN	33826
20	4	BRUSH	33620
19	1	FLANGE	31937
18	1	BEARING 6202 2RSC3GJN	91121
17	2	BASE	34345
16	1	CONNECTION	32059
15	1	CONNECTION	32060
14	2	TERMINAL	34002
13	1	FIELD	31626
12	1	FLANGE	33460
11	1	BEARING 6004 2RSC3GJN	91119
10	1	ARMATURE	31397
9	9	SCREW TCEI M8x54	93637
8	1	WHEEL ø300x101	132101
7	1	SEALING	14310
6	2	BEARING 16024	91111
5	1	OR 3775	91536
4	1	SEALING RING	90111
3	1	SEALING RING	13806
2	2	BEARING 6206 2Z	91133
1	1	IRON CASTING	13039

B	GEARS	12941
A	GEARS	12942

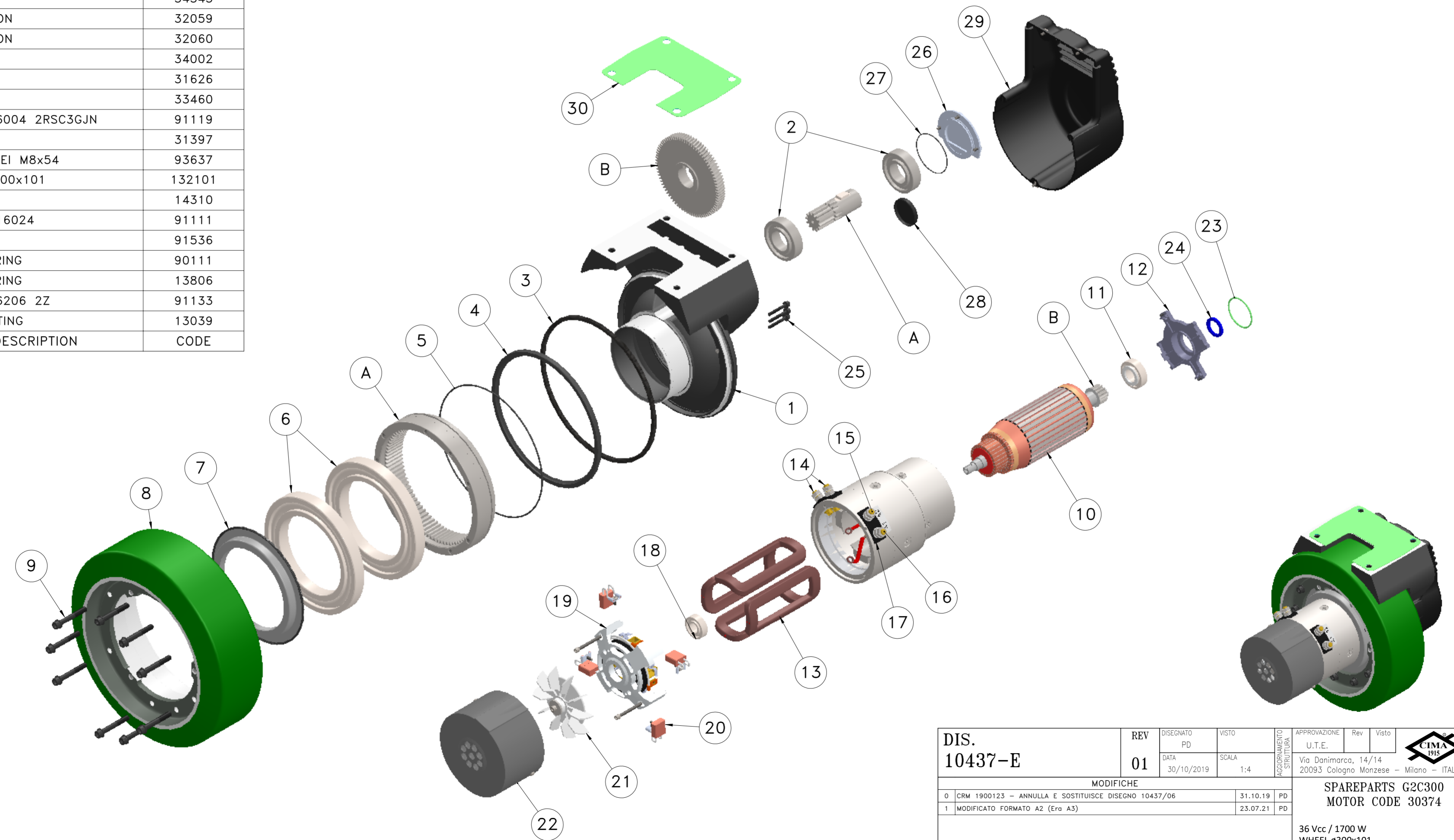

DIS. 10437-E	REV 01	DESIGNATO PD	VISTO	APPROVAZIONE U.T.E.	Rev	Visto	
		DATA 30/10/2019	SCALA 1:4	AGGIORNAMENTO STRUTTURA	Via Danimarca, 14/14 20093 Cologno Monzese - Milano - ITALY		
MODIFICHE							
0	CRM 1900123 - ANNULLA E SOSTITUISCE DISEGNO 10437/06	31.10.19	PD	SPAREPARTS G2C300 MOTOR CODE 30374			
1	MODIFICATO FORMATO A2 (Era A3)	23.07.21	PD	36 Vcc / 1700 W WHEEL ø300x101 POLIURETHANE GREEN ABRADED 75 Sh.			
				Project Nr.			

Formato: A2 - Disegno eseguito con SW non sono ammesse variazioni o modifiche manuali.